

Art.	Pag.	Art.	Pag.	Art.	Pag.
E.4	86	E.96	96	E.1004	115
E.5	86	E.97	98	E.1005	115
E.6	86	E.98	98	E.1006	114
E.7	86	E.99	98	E.1007	116
E.18	88	E.100	98	E.1014	
E.19	88	E.101	99	E.1015	116
E.20	88	E.102	99	E.1016	117
E.21	88	E.103	91	E.1017	116
E.22	88	E.104	91	E.1018	118
E.23	88	E.105	91	E.1019	118
E.27	87	E.106	91	E.1020	118
E.28	87	E.107	91	E.1022	120
E.29	87	E.108	91	E.1023	120
E.30	87	E.109	91	E.1024	117
E.31	87	E.110	97	E.1025	118
E.32	87	E.111	97	E.1026	118
E.33	87	E.112	97	E.1029	121
E.34	87	E.113	104	E.1030	121
E.43	90	E.117	96	E.1031	120
E.44	90	E.118	97	E.1032	114
E.45	90	E.120	97		
E.46	90	E.120 - 03	97		
E.47	90	E.121	106		
E.48	90	E.122	106		
E.49	90	E.123	106		
E.50	100	E.124	106		
E.51	100	E.125	99		
E.52	100	E.126	94		
E.53	100	E.127	94		
E.57	96	E.128	89		
E.58	96	E.129	89		
E.65	94	E.133	94		
E.66	94	E.134	94		
E.67	94	E.139	106		
E.68	92	E.140	93		
E.69	92	E.141	93		
E.70	92	E.142	95		
E.71	92	E.143	95		
E.72	100	E.144	95		
E.73	100	E.145	95		
E.74	100	E.146	91		
E.75	100	E.147	91		
E.76	102	E.148	110		
E.77	102	E.149	110, 113		
E.78	102	E.150	111, 113		
E.79	102	E.151	111		
E.80	102	E.152	110		
E.81	94	E.153	110		
E.83	98	E.154	113		
E.85	98	E.155	113		
E.86	89	E.156	113		
E.87	89	E.157	113		
E.88	89	E.158	112		
E.89	89	E.159	112		
E.90	101	E.160	112		
E.91	101	E.161	112		
E.92	101				
E.93	101	E.1001	114		
E.94	96	E.1002	114		
E.95	96	E.1003	115		

# INDICE

## INDEX



**GHIDINI**  
GIUSEPPE BOSCO

---

**Copricentri**  
Cover bodies  
Couvre centres  
Abdeckung  
Cubrecentros  
Pokrycia s'rodkòw  
Крышки центральные  
декоративные

# E

ARTICOLO ITEM	Ø	H
E 4	200	69
E 5	140	58
E 6	100	41
E 7	80	34

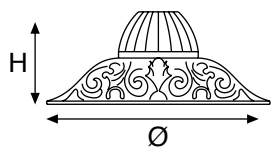

E.4



E.5



E.6



E.7

ARTICOLO ITEM	Ø	H
E 27	50	10
E 28	60	13
E 29	70	15
E 30	80	16
E 31	90	20
E 32	100	21
E 33	120	26
E 34	140	30



E.34



E.30



E.33



E.29



E.32



E.28



E.31



E.27

# E



E.23



E.22



E.21



E.20



E.19



E.18

ARTICOLO ITEM	Ø	H
E 18	50	26
E 19	60	30
E 20	70	34
E 21	80	40
E 22	90	45
E 23	100	48



E.89



E.86



E.87



E.88



E.128



E.129

ARTICOLO ITEM	Ø	H	Ø SUP Ø TOP
E 86	100	19	-
E 87	80	15	-
E 88	60	12	-
E 89	50	10	-
E 128	80	6	50,5
E 129	100	12	50,5

# E



E.46



E.47



E.48



E.49

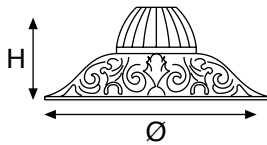

E.45



E.44



E.43

ARTICOLO ITEM	Ø	H
E 43	80	22
E 44	100	27
E 45	140	28
E 46	80	34
E 47	100	42
E 48	140	60
E 49	160	67



E.109



E.147



E.108



E.107



E.106



E.105



E.104



E.103



E.146

ARTICOLO ITEM	Ø	H
E 103	80	27
E 104	90	31
E 105	100	34
E 106	110	37
E 107	120	41
E 108	140	47
E 109	160	53
E 146	60	22
E 147	200	60



# E

ARTICOLO ITEM	Ø	H
E 68	80	25
E 69	100	30
E 70	140	40
E 71	200	60



E.68 ø 80



E.69 ø 100



E.70 ø 140



E.71 ø 200

ARTICOLO ITEM	Ø	H
E 140	240	65
E 141	307	77



E.140 ø 240



E.141 ø 307



E.66 ø 100



E.67 ø 140



E.65 ø 80



E.81



E.134 ø 140



E.127 ø 100



E.126 ø 80



E.133 ø 60

ARTICOLO ITEM	Ø MAX	Ø SUP. Ø TOP	H
E 65	80	-	25
E 66	100	-	30
E 67	140	-	40
E 81	114	-	49
E 126	80	50	20
E 127	100	60	20
E 133	60	40	15
E 134	140	80	25



E.145 ø 200



E.144 ø 160



E.143 ø 120



E.142 ø 100



L.123 ø 80



L.121 ø 60

ARTICOLO ITEM	Ø	H
E 142	100	38
E 143	120	44
E 144	160	54
E 145	200	65
L 121	60	27
L 123	80	36

# E



E.57



E.58



E.94 ø 120



E.117 ø 100



E.95



E.96

ARTICOLO ITEM	Ø	H	Ø SUP Ø TOP
E 57	100	25	
E 58	80	20	
E 94	120	53	
E 95	140	37	85
E 96	140	36	85
E 117	100	46	

ARTICOLO ITEM	Ø	H	Ø SUP	FORI HOLES
E 110	80	20		
E 111	110	31		
E 112	140	29		
E 118	70	18		
E 120	90	30	35	
E 120-03	90	30	35	3 holes



E.118 ø 70



E.110 ø 80

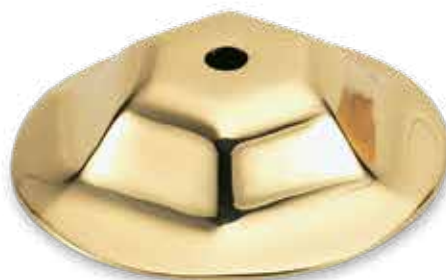

E.111 ø 110



E.112 ø 140



E.120 - 03



E.120

# E



E.85



E.83



E.100



E.99



E.97



E.98

ARTICOLO ITEM	Ø MAX	Ø INT	H
E 83	60	55	22
E 85	150	140	112
E 97	100	-	25
E 98	90	-	21
E 99	93	-	24
E 100	75	70	26

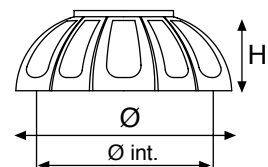



E.101



E.102

ARTICOLO ITEM	Ø MAX	Ø INT	H
E 101	140	80	33
E 102	200	120	34
E 125	100	-	30
L 74	70	-	20



E.125



L.74



# E



E.50 ø 140  
E.72 TORN



E.51 ø 120  
E.73 TORN



E.52 ø 100  
E.74 TORN



E.53 ø 80  
E.75 TORN

ARTICOLO ITEM	Ø	H
E 50	140	54
E 51	120	43
E 52	100	34
E 53	80	28
E 72 Torn	140	54
E 73 Torn	120	43
E 74 Torn	100	80
E 75 Torn	80	28



E.93 ø 100

ARTICOLO ITEM	Ø	H
E 90	70	23
E 91	90	25
E 92	150	37
E 93	100	62

Articoli torniti / Machined items



E.92 ø 150



E.91 ø 90



E.90 ø 70



E.80



E.79

ARTICOLO ITEM	Ø	H
E 76	80	29
E 77	100	37
E 78	120	45
E 79	140	52
E 80	160	58

Articoli torniti / Machined items



E.78



E.76



E.77



L.86 ø 100



L.85 ø 70



L.97 ø 120



L.93 ø 100

ARTICOLO ITEM	Ø	H
L 85	70	20
L 86	100	28
L 92	80	11
L 93	100	14
L 95	50	8
L 96	60	8
L 97	120	17



L.92 ø 80



L.96 ø 60



L.95 ø 50

# E

ARTICOLO ITEM	Ø MAX	H	Ø INT
<b>F 67</b>	90	3,5	70
<b>F 68</b>	160	3,5	130
<b>F 71</b>	120	3,5	92



E.71



F.67



F.68



E.113

ARTICOLO ITEM	Ø MAX	H	IMPOSTA SUP TOP COUNTERSINK
<b>E 113</b>	80	35	30
<b>Z 125*</b>	37	13	30

\* Imposta interna Ø 25,2 / Inside countersink Ø 25,2



Z.125



**GHIDINI**  
GIUSEPPE BOSCO



E.124  
Ø 307



E.139  
Ø 240

ARTICOLO ITEM	Ø	H	FORO/FILETTO HOLE/THREAD
E 121	100	35	10,2
E 122	120	38	10,2
E 123	160	47	10,2
E 124	307	56	10x1
E 139	240	50	10x1

Articoli torniti e satinati / Turned and grinded pieces



E.122  
Ø 120



E.123  
Ø 160



E.121  
Ø 100

## LASTRA DI OTTONE / TURNED SPINNING BRASS



4118  
Ø 407



4117  
Ø 307



4126  
Ø 200

ARTICOLO ITEM	Ø	H
4117	307	57
4118	407	70
4126	200	50



# E

## LASTRA DI OTTONE / TURNED SPINNING BRASS

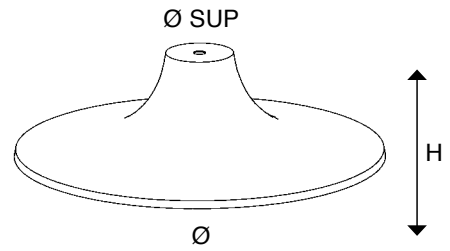

4116  
Ø 407



4115  
Ø 307

## LASTRA DI OTTONE / TURNED SPINNING BRASS

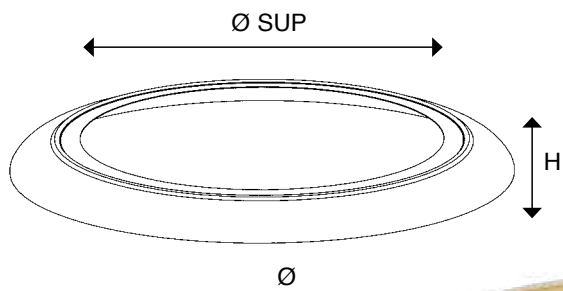

4119  
 $\varnothing$  507

ARTICOLO ITEM	$\varnothing$	H	$\varnothing$ SUP
4115	307	88	56
4116	407	105	56
4119	507	35	407
4156	307	28	250



4156  
 $\varnothing$  307

# E

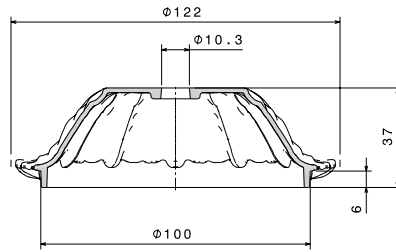

E.148



E.149

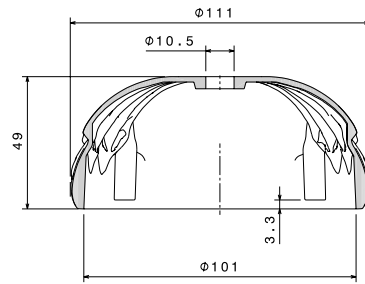

E.153

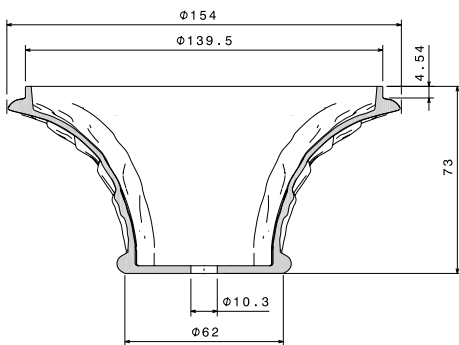

E.152



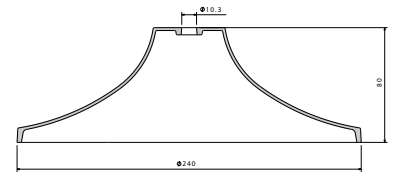

E.151

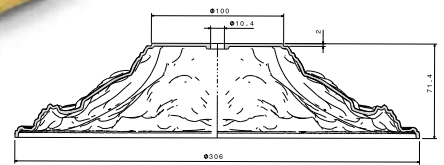

E.150

ARTICOLO ITEM	H	ØMAX.	ØSUP. TOP	ØIMPOSTA ØCOUNTERSINK	FORO HOLE
E 148	37	120	50	100	10,3
E 149	49	111	30	100	10,3
E 150	71	306	100	100	10,3
E 151	80	240	50	-	10,3
E 152	73	154	60	140	10,3
E 153	30	70	17	-	10,3

# E

ARTICOLO ITEM		D1	D2	D3	H	H1	H2	d
<b>E 158</b>	(*)	88,4	24	70,5	146	11	2	10,2
<b>E 159</b>	(*)	292	141	258	66	2,5	2	fil. 10x1
<b>E 160</b>	(*)	140	40	-	33,5	-	-	fil. 10x1
<b>E 161</b>	(*)	265	-	-	11	-	-	fil. 10x1

(\*) Not available for USA market

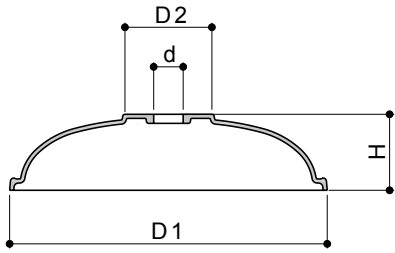

E.160

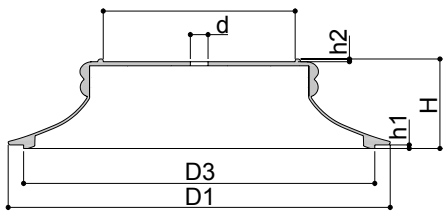
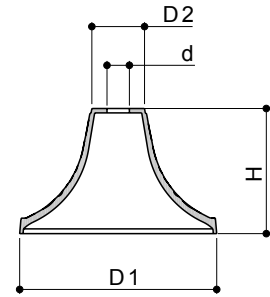

E.158



E.159

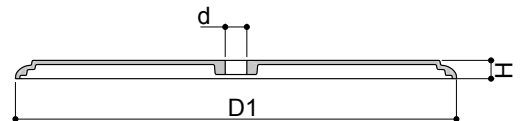
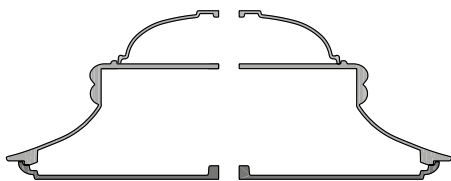

E.161

ARTICOLO ITEM	D1	D2	D3	H	H1	H2	D
E 149	111	101	-	49	-	-	10,2
E 150	306	100	-	71,5	-	-	10,2
E 154	80	16	-	26,5	-	-	10,2
E 155	100	18	-	33	-	-	10,2
E 156	140	21	-	45	-	-	10,2
E 157	200	-	-	64	-	-	10,2



E.154



E.155



E.156



E.157

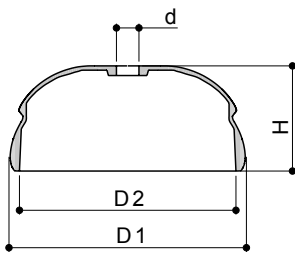

E.149

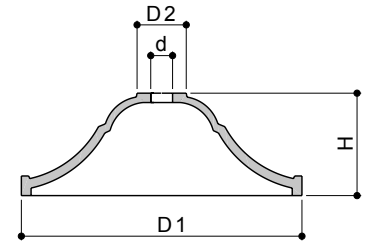

E.150



E.1001



L.1001

ARTICOLO ITEM	Ø	H
<b>E 1001</b>	110	60
<b>E 1002</b>	110	42
<b>E 1006</b>	100	37
<b>E 1032</b>	80	40
<b>L 1001</b>	90	45
<b>L 1002</b>	80	30

Bronze véritable



E.1032



E.1002



E.1006 ø 100

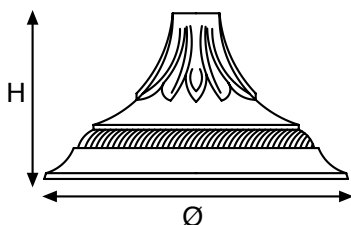

L.1002 ø 80



E.1003



E.1004



E.1005

ARTICOLO ITEM	Ø	H
<b>E 1003</b>	140	60
<b>E 1004</b>	100	42
<b>E 1005</b>	80	34
<b>L 1004</b>	100	39
<b>L 1005</b>	80	32

Bronze véritable



L.1005



L.1004





E.1007



E.1017



E.1015

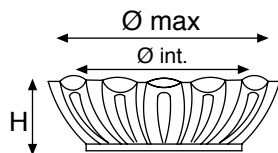

ARTICOLO ITEM	Ø	H	Ø INTERNO Ø INSIDE
<b>E 1007</b>	105	35	100
<b>E 1015</b>	112	58	95
<b>E 1017</b>	50	37	-

Bronze véritable

ARTICOLO ITEM	Ø	H	Ø INTERNO Ø INSIDE
<b>E 1016</b>	153	71	125
<b>E 1024</b>	108	50	100
<b>F 19</b>	100	3,5	
<b>F 1003</b>	125	3	

Bronze véritable



E.1016

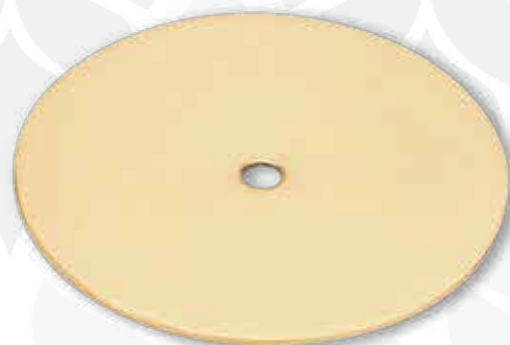

F.1003



E.1024



F.19

# E



E.1026



E.1025

ARTICOLO ITEM	Ø	H	Ø SUP Ø TOP
<b>E 1025</b>	80	26	22
<b>E 1026</b>	100	30	22

Bronze véritable

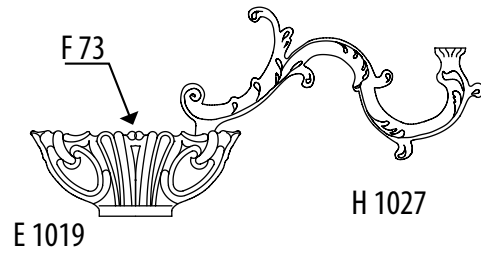

E 1019

H 1027



E.1019



E.1018

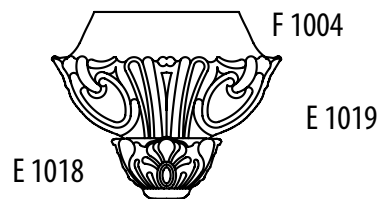

E 1018

E 1019



E.1020

ARTICOLO ITEM	Ø	H	Ø INTERNO Ø INSIDE	Ø INFERIRE Ø BOTTOM
<b>E 1018</b>	82	43	60	24
<b>E 1019</b>	170	67	146	50
<b>E 1020</b>	110	33	100	59

Bronze véritable

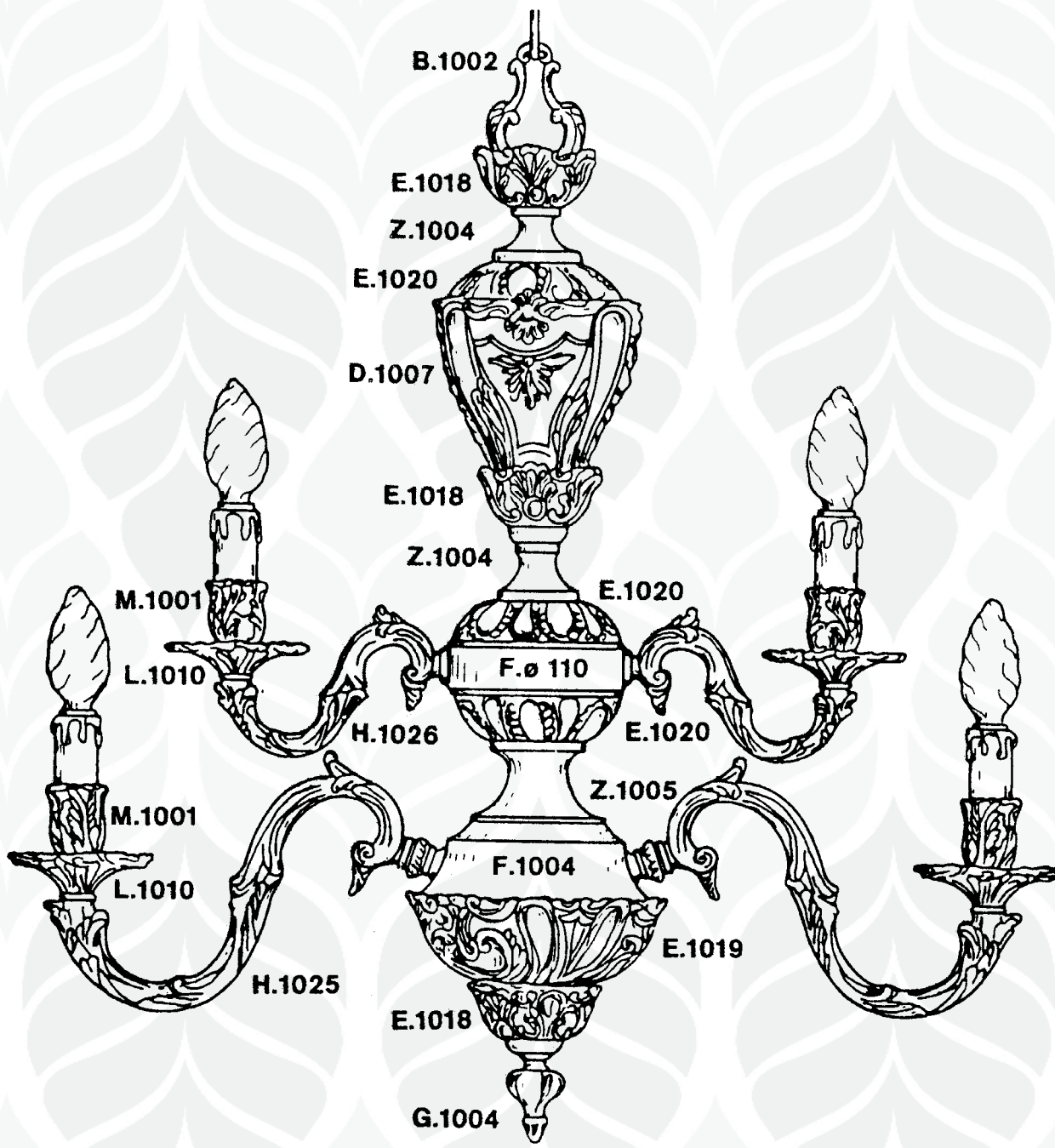

# E

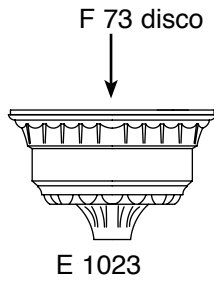

E.1023



E.1022 Ø 160

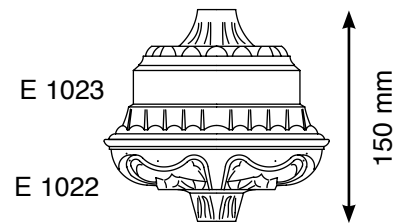

E.1031 Ø 120

ARTICOLO ITEM	Ø	H	FILETTO / FORO THREAD / HOLE
E 1022	160	58	10,2
E 1023 torn	158	93	10x1
E 1029	200	72	10x1
E 1030	300	92	10x1
E 1031	120	43	10,2

Bronze véritable



E.1029 Ø 200



E.1030 Ø 300